

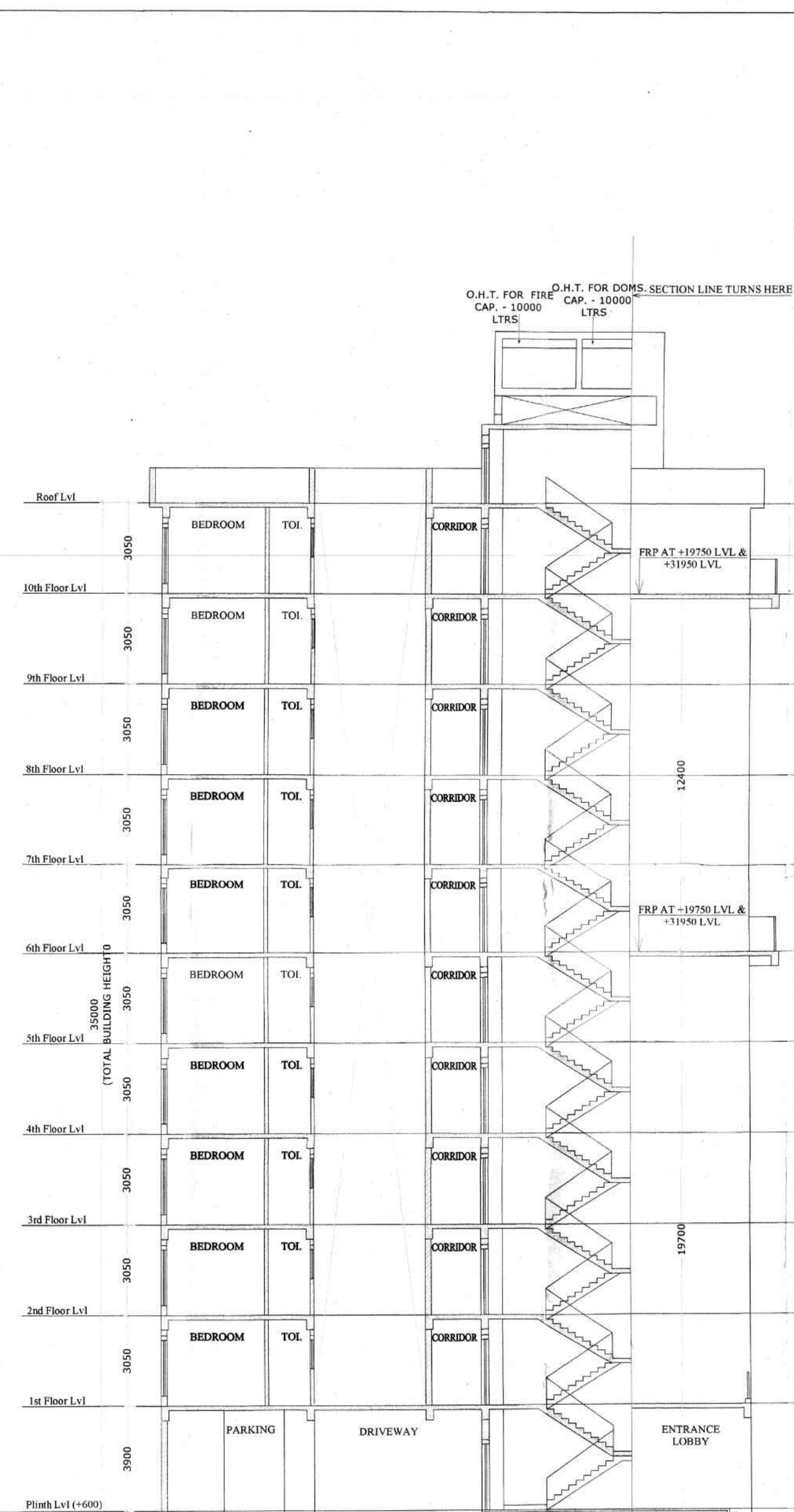

NORTH SIDE ELEVATION
SCALE 1:100



SECTION Y5-Y5
SCALE 1:100

PROJECT: REVISED PLAN SHOWING ADDITION & ALTERATION OF 6 NOS GROUND + 10 STORIED RESIDENTIAL BUILDING AND ONE NO 3 STORIED AMENITY BLOCK

OWNER: 1.MEGASUN MERCHANTS PVT. LTD. REPRESENTED BY ONE OF ITS DIRECTOR SRI. KISHAN AGARWAL
2. KAMAL CHAND BOTHRA
3. ANAND AGARWAL
4. SUSHMA AGARWAL
5. UNITED PROPERTIES PVT. LTD. REPRESENTED BY ITS DIRECTOR VEDAVID BASAK

LOCATION: SISHABARI, SILIGURI

LAND SCHEDULE :
MOUZA :SISHABARI
J.L. NO. 41
L.R.PLOT NO. :257,260,261,255,256,258,&259
R.S. PLOT NO.-118,115,116,117,119,120,121
SHEET NO. :01 (L.R), 01 (R.S)
KHATIAN NO. 3650,3651,3649,3614,2168 (L.R)
P.S. : PRADHAN NAGAR
DIST. DARJEELING
Latitude : 26°46'45.00"(N)
Longitude : 88°25'30.33" (E)

NOTE:
ALL DIMENSION ARE IN MM. OTHERWISE MENTIONED.

DECLARATION OF OWNER'S:-
I DO HEREBY DECLARE THAT THE BUILDING PROPOSED FOR CONSTRUCTION SHALL BE SUPERVISED BY THE B.A./L.B.S. SIGNING THE BUILDING PLAN APPLICATION OR IN HIS ABSENCE BY ANY OTHER B.A./L.B.S. OF THE APPROPRIATE CATEGORY AND AS APPROVED BY THE AUTHORITY.

1) Megasun Merchants Pvt. Ltd.
2) Kamal
3) Anand

Director
Sushma Agarwal United Properties Pvt. Ltd.
N. David Basak Director

SIGNATURE OF OWNER'S

DECLARATION OF STRUCTURAL ENGINEER
THE STRUCTURAL DESIGN AND DRAWING OF BOTH FOUNDATION AND SUPER STRUCTURE OF THE BUILDING HAS BEEN MADE BY ME CONSIDERING ALL POSSIBLE LOADS INCLUDING THE SEISMIC LOAD AS PER THE "NATIONAL BUILDING CODE" OF INDIA AND CERTIFIED THAT IT IS SAFE AND STABLE IN ALL RESPECT. MOREOVER I/WE SHALL BE HELD RESPONSIBLE FOR ANY STRUCTURE DAMAGE/FAILURE HAPPENED DURING CONSTRUCTION PERIOD AND THERE AFTER BEYOND DATE OF TAKING OCCUPANCY CERTIFICATE.

Mainak Majumdar
B.C.E., M.E.C. (Struct)
ESE-1521 of O.C.
STEREOKAM/00000
074R/PSOM/SEPT-12

SIGNATURE OF STRUCTURAL ENGINEER

DESIGNED AND CHECKED BY ME

SIGNATURE OF GEO-TECHNICAL ENGINEER

DECLARATION OF ARCHITECT / L.B.S.
I DO HEREBY DECLARE THAT THE KEY PLAN, SITE PLAN AND THE BUILDING PLAN HAVE BEEN PREPARED UNDER MY SUPERVISION AND I SHALL BE RESPONSIBLE FOR THE SUPERVISION OF THE BUILDING.

Riya Biswas (B.Arci.)
CA/2019/112919

SIGNATURE OF ARCHITECT / L.B.S.

TITLE:- SECTION AND ELEVATION (BLOCK-05)

SCALE:- 1:100
DATE - 18.09.2022
SHEET NO. :- 07
CKD. BY:- K. K. ROY
DRAWN BY:- SHOLANKI

GREEN ARCHITECTURE CONSULTING ENGINEERS PVT. LTD.
1ST FLOOR, B.R. AMBEDKAR COMPLEX, HILL CART ROAD, SILIGURI - 734003

